



PRO30L & PRO31M USER MANUAL



DEAR CUSTOMER

Congratulations on the purchase of your new DuraVac wet/dry vacuum cleaner.



Prior to using the appliance for the first time, be sure to read this document through and keep it ready to read instructions of use.

PURPOSE AND INTENDED USE

This vacuum cleaner is designed, developed and rigorously tested to function efficiently and safely when properly maintained and used in accordance with the following instructions. This vacuum cleaner is to be used for commercial (hotels, schools, hospitals, factories, offices and rental business) and/or for household use. Accidents due to misuse can only be prevented by those using the machine.

CAUTION: READ AND FOLLOW ALL SAFETY INSTRUCTIONS.

This machine is suitable for picking up dry, nonflammable dust and liquids.

Any other use is considered as improper use. The manufacturer accepts no liability for any damage resulting from such use. The risk for such use is borne solely by the user. Proper use also includes proper operation, servicing and repairs as specified by the supplier.

! ATTENTION: REVIEW IMPORTANT SAFETY INSTRUCTIONS BEFORE ATTEMPTING TO USE THIS VACUUM CLEANER. RETAIN FOR FUTURE REFERENCE

! DANGER: Never operate this unit when flammable materials or vapors are present because electrical devices produce arcs or sparks that can cause a fire or explosion.

NEVER OPERATE UNATTENDED!



! WARNING: Always wear eye protection to prevent rocks or debris from being blown or ricocheting into the eyes or face which can result in serious injury.

1. IMPORTANT SAFETY INSTRUCTIONS**1.1 INSTRUCTIONS FOR USE:**

The appliance must:

- only be used by persons, who have been instructed in its correct usage and explicitly commissioned with the task of operating it
- only be operated under supervision
- This appliance is not intended for use by persons (including children) with reduced physical, sensory or mental capabilities, or lack of experience and knowledge.
- Children shall be supervised to make sure that they do not play with the appliance.
- Do not use any unsafe work techniques.
- Never use the vacuum cleaner without a filter.
- Switch off the appliance and disconnect the mains plug in the following situations:
 - o Prior to cleaning and servicing
 - o Prior to replacing components
 - o Prior to changing over the appliance
 - o If foam develops or liquid emerges

Besides the operating instructions and the binding accident prevention regulations valid in the country of use, observe recognised regulations for safety and proper use.

1.2 IMPORTANT WARNINGS:

- To reduce the risk of fire, electric shock, or injury, please read and follow all safety instructions and caution markings before use. This vacuum cleaner is designed to be safe when used for cleaning functions as specified. Should damage occur to electrical or mechanical parts, the cleaner and / or accessory should be repaired by a competent service station or the supplier before use in order to avoid further damage to the machine or physical injury to the user.
- Do not leave the machine when it is plugged in. Unplug from the socket when not in use and before maintenance.
- Do not use with damaged cord or plug. To unplug grasp the plug, not the cord. Do not handle plug or cleaner with wet hands. Turn off all controls before unplugging.
- Do not pull or carry by cord, use cord as a handle, close a door on cord, or pull cord around sharp edges or corners. Do not run cleaner over cord. Keep cord away from heated surfaces.
- Keep hair, loose clothing, fingers and all parts of the body away from openings and moving parts.
- Do not put any objects into openings or use with opening blocked. Keep openings free of dust, lint, hair, and anything else that could reduce the flow of air.
- **WARNING:** This machine is not suitable for picking up hazardous dust.
- Do not use to pick up flammable or combustible liquids such as gasoline, or use in areas where they may be present.
- Do not pick up anything that is burning or smoking, such as cigarettes, matches or hot ashes.
- Use extra care when cleaning on stairs.
- Do not use unless filters are fitted.
- If the cleaner is not working properly or has been dropped, damaged, left outdoors, or dropped into water, return it to a service center or supplier.
- If foam or liquid escapes from the machine, switch off immediately.
- The vacuum cleaner may not be used as a water pump. The vacuum cleaner is intended for vacuuming air and water mixtures.
- Connect the vacuum cleaner to a properly earthed mains supply. The socket outlet and the extension cable must have an operative protective conductor.
- Provide for good ventilation at the working place.
- Do not use the vacuum cleaner as a ladder or step ladder. The vacuum cleaner can tip over and become damaged.
- Never vacuum up the following materials: explosive or combustible gases, liquids and dust particles (reactive dust particles), reactive metal dust particles (such as aluminum, magnesium, zinc) in combination with highly alkaline or acidic detergents, undiluted and strong acids and alkalis or organic solvents such as petrol, paint thinners, acetone, heating oil and similar products.
- Risk of fire. Do not vacuum up any burning or glowing objects.
- Do not pick up flammable or combustible liquids such as gasoline, liquids, reactive dust particles or use in areas where they may be present.
- Do not use your vacuum cleaner as a sprayer of flammable liquids such as oil base paints, lacquers, household cleaners, etc.
- Do not attempt to vacuum hot or warm ashes. Maximum temperature of ashes should not be warmer than 102 degrees Fahrenheit / 40 degrees Celsius.
- Do not vacuum toxic carcinogenic, combustible or other hazardous materials such as asbestos, arsenic, barium, beryllium, lead, pesticides or other health endangering materials.
- To avoid spontaneous combustion, empty tank after each use.

- NOTE: A static shock may occur if the environment is too dry. This will not affect the use of the vacuum cleaner. To eliminate shock, add humidity to the air with a console or a humidifier.
- STAY ALERT and use common sense. Do not use vacuum cleaner when you are under the influence of drugs, alcohol, medication, or if you are tired or distracted.
- Do not leave cord lying on the floor once you have finished the cleaning job. It can become a tripping hazard.
- If the supply cord is damaged, it must be replaced by the manufacturer, its service agent or similar qualified persons in order to avoid hazard
- Do not allow to be used as a toy. Close attention is necessary when used by or near children.
- Keep packaging material away from children. There is a risk of suffocation!
- Protect the unit from rain. Store indoors only.
- CAUTION: The machine is for indoor use only.
- Do not operate the vacuum cleaner in the rain.
- Wear protection mask, when tank is emptied for fine dust of all kinds.
- Unplug before connecting hose and any attachments.
- Do not leave appliance when plugged in. Unplug from outlet when not in use and before servicing it.
- Connect to a properly grounded outlet only. See Grounding Instructions.
- WARNING: Operators shall be adequately instructed on the use of these machines
- CAUTION: Clean the water level limiting device regularly and examine it for signs of damage.
- The floater has the function to stop the vacuuming when the tank is full of fluids or in case of overturning; carry out routine cleaning, checking that it has no damage and change it if necessary.

1.4 Tests and approvals

Electrical tests must be performed in accordance with the provisions of safety regulations EN 62638. These tests must be performed at regular intervals and after repairs or modifications. The vacuum cleaner has been approved in accordance with IEC/EN 60335-2-69.

Note: All the drawings and pictures are merely indicative and given only as a guide.

2. OVERVIEW

FIG. 1

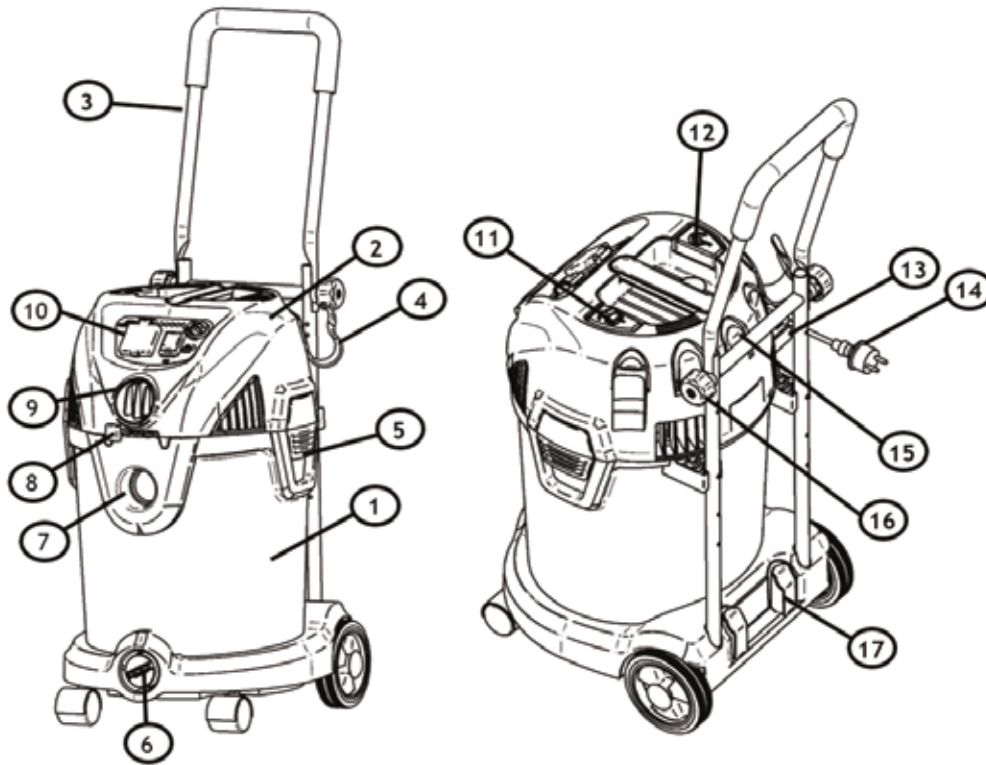

- 1. Tank
- 2. Head
- 3. Trolley (optional)
- 4. Hose and cord storage hook (optional)
- 5. Clamp
- 6. Drain outlet
- 7. Suction inlet
- 8. Blow regulation
- 9. Blow outlet
- 10. Control panel

- 11. Filter Cleaning Button (optional)
- 12. Cord rewind button (optional)
- 13. Plug seat
- 14. Cord Plug
- 15. Nozzle storage holders
- 16. Trolley lock screw
- 17. Tube storage holders

FIG. 2

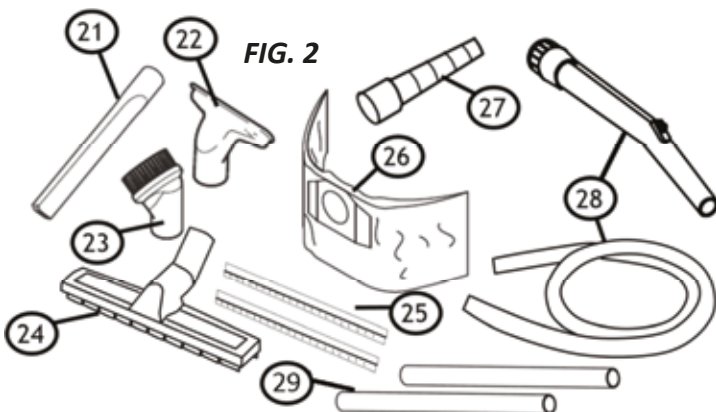

- 21. Crevice Nozzle
- 22. Upholstery nozzle (optional)
- 23. Brush nozzle
- 24. Floor nozzle (dry pickup)
- 25. Squeegee insert (wet pickup)
- 26. Dust bag
- 27. Power tool adapter (optional)
- 28. Hose with handtube
- 29. Hoses

Some of these accessories are packed inside the tank. **If parts are missing, contact our Customer Service Dep.**

3. FIRST TIME SET UP INSTRUCTIONS

Read chapter 1 – **IMPORTANT SAFETY INSTRUCTIONS** of this manual thoroughly before setting up and using this vacuum cleaner.

3.1 ACCESSORIES

The nozzles and accessories for the machine is during shipping stored in tank. To open the tank open the clamps and take off the head. Take out the items and put on the head again. Secure the head with the clamps.

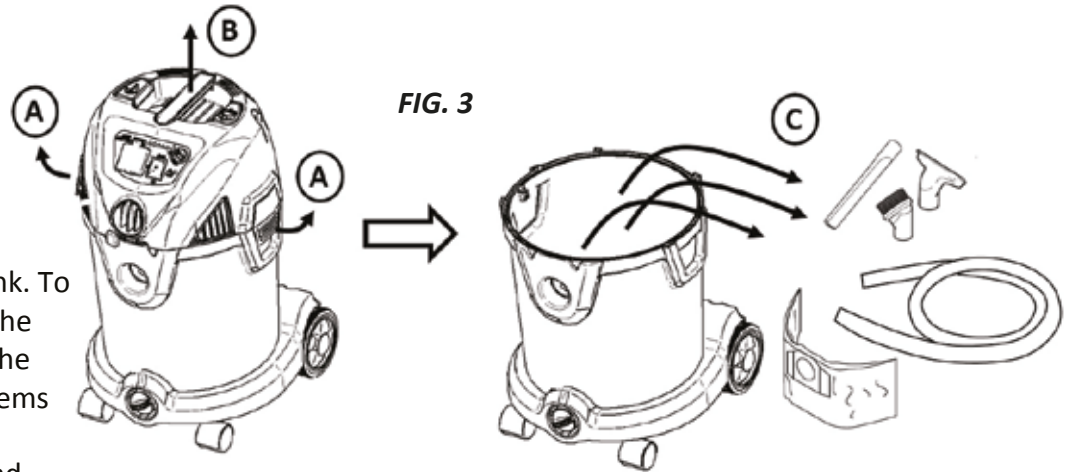

See chapter 6 where to store the accessories on the machine.

3.2 MOUNTING OF HOSE AND CORD HOLDER

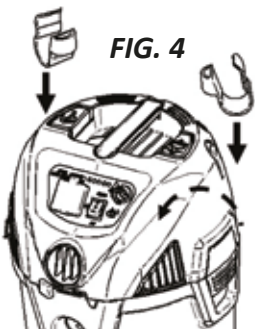

Add the two hose/cord holders in the appropriate receptable on the head

3.3 PREPARING THE TROLLEY (OPTIONAL)

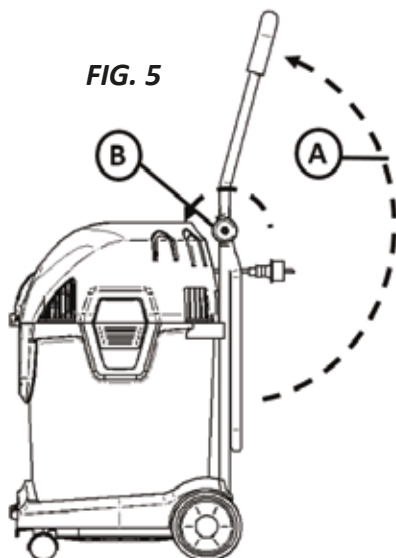

The trolley can be folded during transportation. To fix it in the upright position swing the top trolley part up (A) and fix it with the 2 screws (B). Make sure to tighten both sides equal.

4. USING THE VACUUM CLEANER

Read chapter 1 – **IMPORTANT SAFETY INSTRUCTIONS** of this manual thoroughly before setting up and using this vacuum cleaner.

4.1 WORKING WITH DUST BAGS

If sucking up dry dust an optional dust bag can be used to collect the dust and ease the disposal. To insert the dust bag take off the head (see also figure 3). Insert the dustbag like shown on figure 6. Put on the head again and secure the head with the clamps.

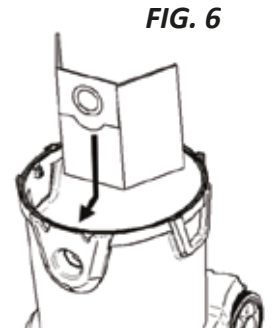

4.2 DRY OR WET FLOOR SUCTION

FIG. 7

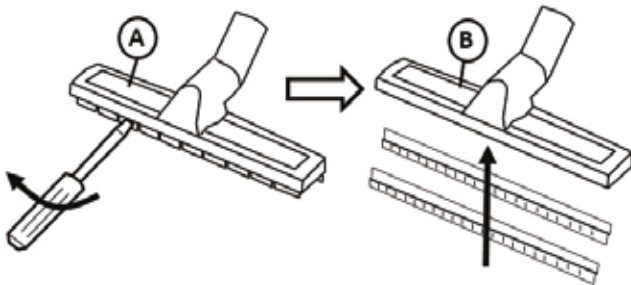

To suck up dry dust and debris use the dry floor nozzle **(A)** with the bristles rim.
To suck up wet debris replace the brush rim with a screwdriver and insert the rubber squeegees

4.3 VACUMING - INSERTING AND REMOVING THE HOSE

To vacuum insert the hose **(A)** into the suction inlet **(B)**.
To remove the hose twist and pull in one movement to remove **(C)**

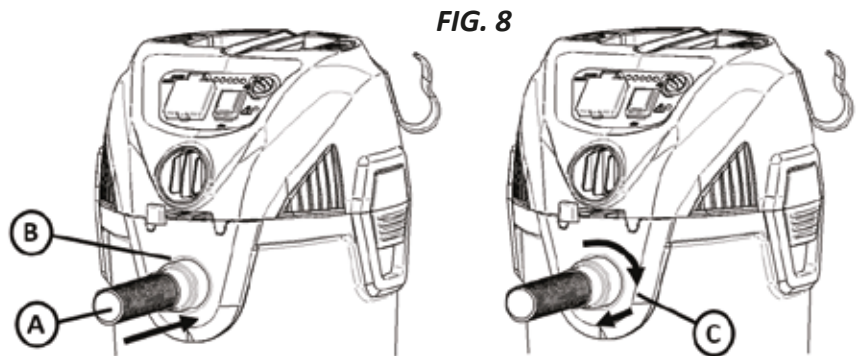
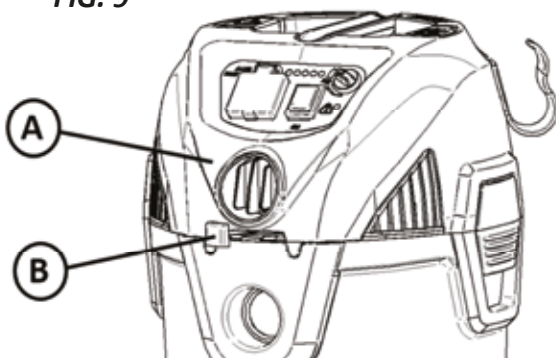

FIG. 9



4.4 BLOWING - INSERTING AND REMOVING THE HOSE

The machine can also be used for blowing. In some cases it is easier first to blow the debris away and then afterwards collect it.

To use the blow function insert the hose into the blow outlet **(A)** in the same way for the suction inlet. See above. The blowing can be controlled by the lever **(B)**

4.5 TURNING THE MACHINE ON

The machine is turned on/off by pressing the start/ stop button (A).

The machine can optionally be equipped with LEDs with power control (C). By turning the knob the suction of the machine can be controlled. The suction performance is also shown by the LEDs. If equipped with LED the 1st LED from left, when the machine is plugged in, will be ON.

To use the optional socket (B) see next chapter.

The machine can optionally be configured with an indicator (D). The indicator goes on, when the underpressure is high. This can be due to the filter being clogged and needs to be cleaned (see later chapter) or the bag is full and need to be replaced.

FIG. 10

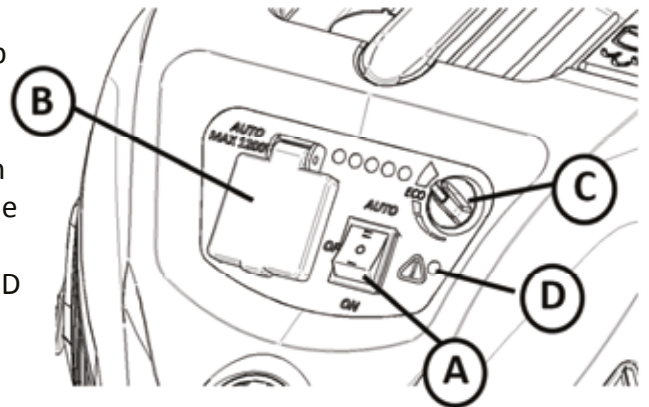

4.6 MACHINE WITH SOCKET AND AUTO START/STOP (OPTIONAL)

The machine can optionally be equipped with a socket that can be used in connecting with a power tool. Connect the power tool to the socket (A). Remove the handtube and fix the conical adapter (B). Insert the conical adapter to the power tool (C). Turn the machine to AUTO mode with the switch (D). The machine will then start, when the power tool is turned on and stop with a delay (in order to empty the hose) when the power tool is turned off.

FIG. 11

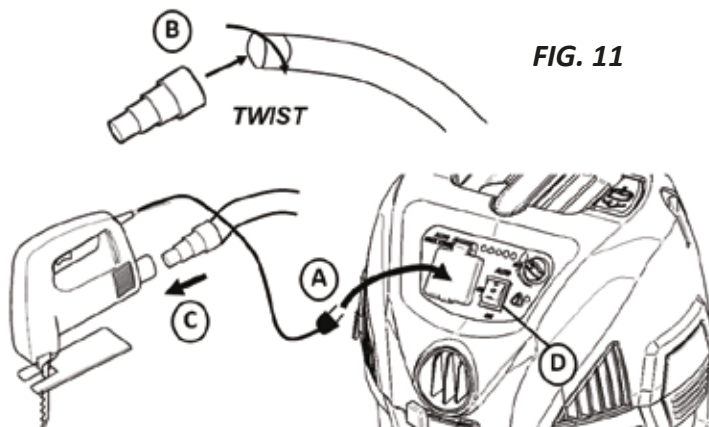

! WARNING - Do not operate without filter basket and float, as they prevent liquid from entering the impeller and damaging the motor. Do not suck up any liquids without a sponge filter installed.



! WARNING - To reduce the risk of back injury or falls, do not lift a vacuum cleaner heavy with liquid or debris. Scoop or drain enough contents out to make the vacuum cleaner light enough to lift in a comfortable manner.

NOTE: IF ACCIDENTALLY TIPPED OVER, THE VACUUM COULD LOSE SUCTION. IF THIS OCCURS, PLACE VAC IN UPRIGHT POSITION AND TURN SWITCH OFF. THIS WILL ALLOW THE FLOAT TO RETURN TO ITS NORMAL POSITION, AND YOU WILL BE ABLE TO CONTINUE OPERATION.



! WARNING - Read the Safety Warnings and Instructions concerning the types of wet materials that cannot be vacuumed with this product.



! DANGER - This equipment incorporates parts such as switches, motors or the like that tend to produce arcs or sparks that can cause an explosion. Do not pick up flammable, combustible, or hot materials. Do not use around explosive liquids or vapors, as electrical devices produce arcs or sparks which can cause a fire or explosion - do not use at filling stations or anywhere gasoline is stored or dispensed.



This vacuum cleaner has a built in thermal overload protector to protect the motor from high temperatures. This can occur under heavy use. If the motor temperature shuts off during operation, turn the switch off and allow the motor to cool for 5 minutes. Turn switch on and resume operation.

4.7 EMPTYING THE TANK FOR LIQUID

To empty the tank for liquid unscrew the drain plug (A) and remove it.

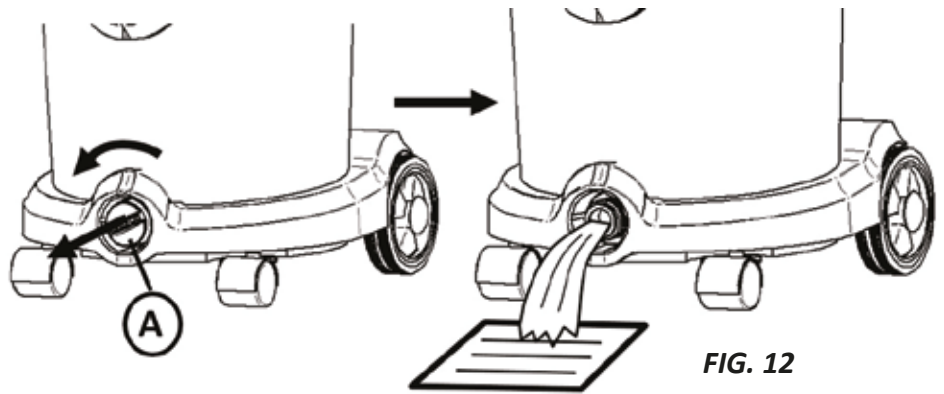
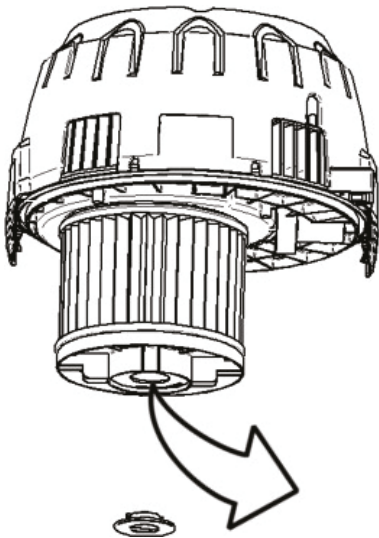

FIG. 12



Discharge water from filter.

4.8 EMPTYING THE TANK FOR DUST/DEBRIS

To empty the tank for dust/debris take off the head (see chapter 3.1). If using a dust bag remove the dust bag and insert a new.

Machines with plastic tanks are equipped with a handle (A) that can be using during disposal of the dust/debris.

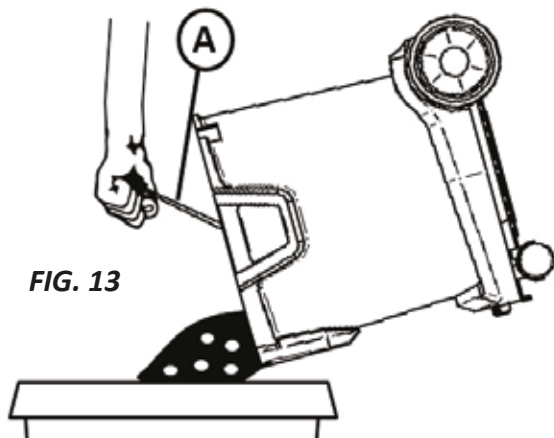

FIG. 13

5. FILTER CLEANING

The machine can optionally be equipped with a semi automatic filter cleaning system or fully automatic filter cleaning system.

5.1 MANUAL FILTER CLEANING

When sucking fine dust the filter will eventually get clogged and suction will go down. The filter therefore needs to be cleaned to restore suction. If the machine is not equipped with semi- or fully automatic filter cleaning system (see next chapters), the filter can be cleaned in the following manual way. Turn the knob **(A)** and remove the knob from the filter disc **(B)**. Remove the filter **(C)**. Clean the filter under cold water **(D)**. Let it dry **(E)** until completely dry. Install backwards by adding filter **(F)**. Fixing the filter disc **(G)** and securing it with the knob **(H)**.

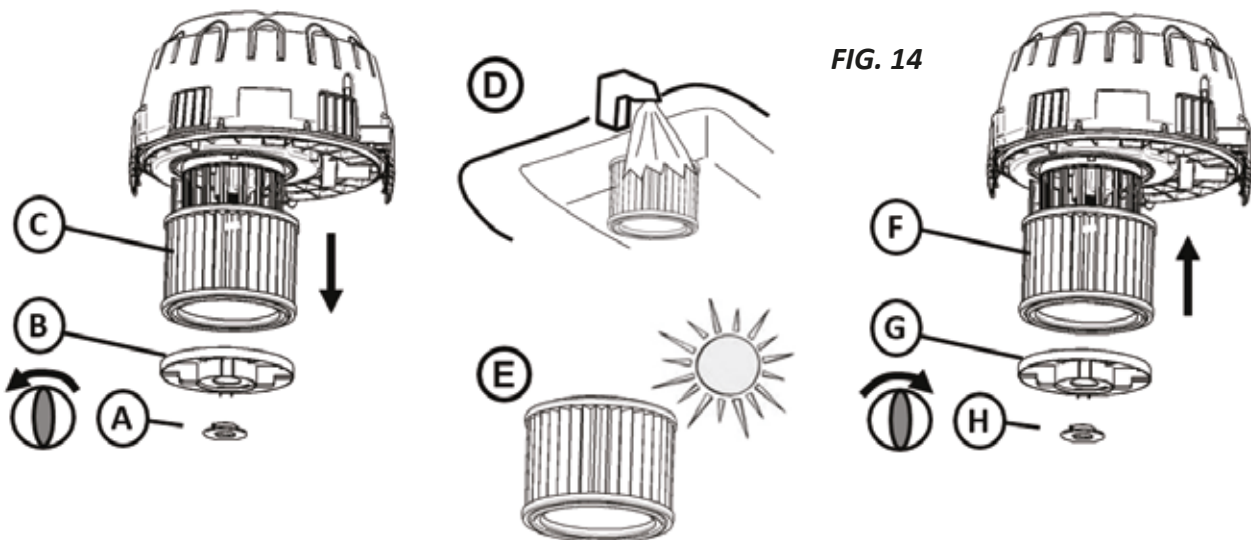

5.2 SEMI AUTOMATIC FILTER CLEANING (OPTIONAL)

When the machine is equipped with the semi automatic filter cleaning system, the filter can be cleaned by closing the inlet of the handtube **(A)**. However, first turn the machine to max. power if equipped with power control (see figure 10). Close the inlet which can be done with your hand or the receptacle/hole in the machine **(B)** can be used. After closing the inlet wait 2-3 seconds until the maximum underpressure has been built up. Press the filter cleaning button **(C)** 5 times fast after each other. This action will clean the filter and restore suction performance.

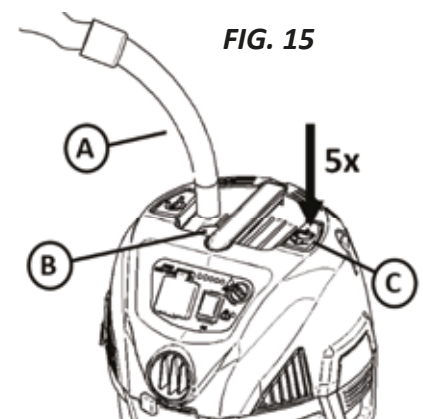

5.3 FULLY AUTOMATIC FILTER CLEANING (OPTIONAL)

The fully automatic filter cleaning system cleans the filter automatically approx. every 20 seconds. The filter cleaning takes less than a second and a very little interruption of the suction performance takes place during the filter cleaning. A small “bang” can be heard. The automatic filter cleaning system works best, when the underpressure in the machine is high. If filter for some reason should be clogged and suction is low then turn the machine to max. power (if configured with power controller) then close the inlet of the machine and wait until a small “bang” can be heard. The filter will then be cleaned and suction restored.

6. DURING OR AFTER USE, STORAGE

Store vacuum cleaner INDOOR in a room above 0°C and store in a dry room.

The tubes can be stored either single (A) on the back of the machine e.g. when the machine is being moved from one place to the other or together (B) via the parking hook/function in between use.

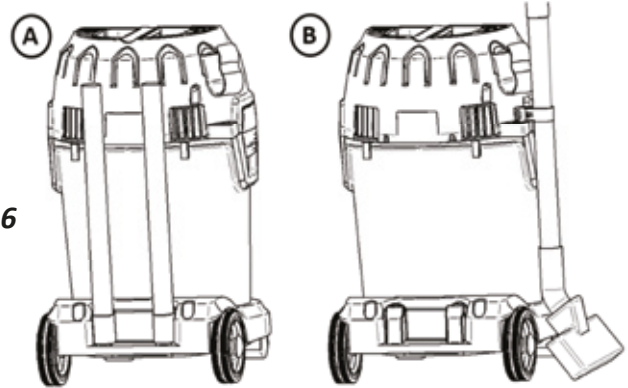

FIG. 16

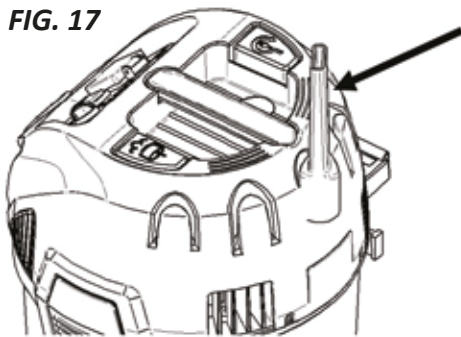

FIG. 17

The nozzles can be stored in the accessory holders on the head

For machine without cord rewriter the cord (A) can be stored in the hooks. These hooks can also be used for storing the hose (B) by coiling it around the machine

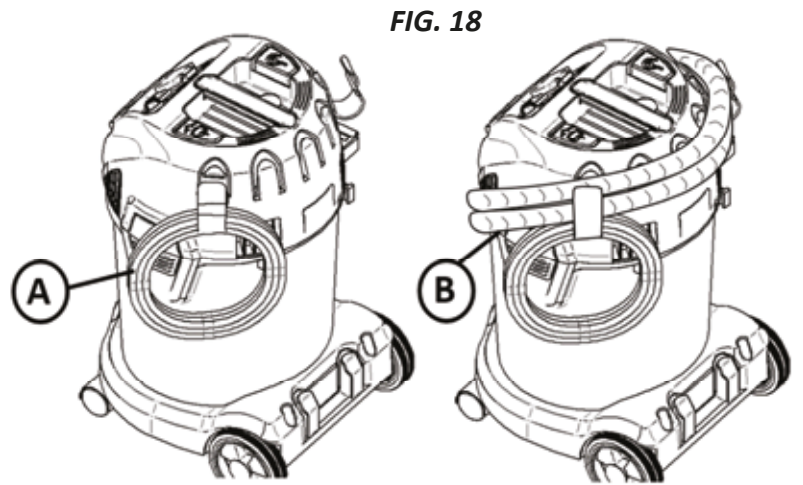

FIG. 18



FIG. 19

When transporting from one place to another the tubes can be put on the handle as seen on figure



WARNING! When not in use: disconnect the power cord from the electrical outlet.



7. TROUBLE SHOOTING

Repair or service of electrical components such as cord or motor, must only be carried out by an authorized service center.

Vacuum does not start:	<ul style="list-style-type: none"> • Check to see that the plug is correctly inserted in the electrical outlet and that there is power at receptacle. • A circuit breaker may have tripped. Check the circuit breaker box. • The cord or plug may be damaged. Call the Customer Service Department to get the nearest authorized service center.
Motor does not run in automatic mode	<ul style="list-style-type: none"> • Power tool defective or not connected properly. Check that the power tool works or that the plug is inserted correctly. • The power rating of the electrical tool is too low. Note that minimum power rating is P>50W
Motor stops:	<ul style="list-style-type: none"> • A thermal overload protector will shut off the motor if the motor temperature is too high. If this occurs, turn the switch off. Wait 10 minutes for the motor to cool. Turn switch on and resume operation.
Suction power is reduced:	<ul style="list-style-type: none"> • The tank may be full and needs to be emptied. See chapter 4.7 and 4.8. • The wands, hose and nozzle may be clogged and need to be cleaned. • Any of the above may be damaged and need to be replaced. • The filter may be clogged. Use the Filter Cleaning System (see chapter 5), to clean the filter. • Check the filter and replace it, if it's necessary. Make sure that is installed properly. • The hose connection is loose and need to be tightened.
Static shocks:	<ul style="list-style-type: none"> • If the environment is too dry, add moisture to air. If possible, use a humidifier. • In case the relative humidity of air is low, please note that this situation will not have any effect on use of the vacuum cleaner.

9. PRODUCT SPECIFICATIONS

Repair or service of electrical components such as cord or motor, must only be carried out by an authorized service center.

Model name	PRO30L	PRO31M
Voltage	220-240V	220-240V
Frequency	50Hz/60Hz	50Hz/60Hz
Power	1000 W	1000 W
Connected load for appliance socket	2400 W	2400 W
Total Power	3600 W	3600 W
Protection Class	L-Class	M-Class
Tank volume	30L	30L
Vibration	ah< 2.5 m/s ²	ah< 2.5 m/s ²
Pressure level at a distance of 1 m, EN 60704-1	76 +/- -2 dB(A)	76 +/- -2 dB(A)
Power level	86 +/- -2 dB(A)	86 +/- -2 dB(A)
	Antistatic	Antistatic
		

Warranty

Whilst every effort is made to ensure your complete satisfaction with this tool, occasionally, due to the mass manufacturing techniques, a tool may not live up to our required level of performance and you may need the assistance of our service department.

This product is warranted for 12 months use from the date of the original purchase. If found to be defective in materials or workmanship, the tool or the offending faulty component will be replaced free of charge with another of the same item. A small freight charge may apply. Proof of purchase is essential.

We reserve the right to reject any claim where the purchase cannot be verified. This warranty does not include damage or defects to the tool caused by or resulting from abuse, accidents, alterations or commercial or business use. It also does not cover any bonus items or included accessories. Only the generator is covered under this warranty.

Please ensure that you store your receipt in a safe place. Conditions apply to the above warranty.

1. DURATION:

The manufacturer warrants that it will repair or replace, at no charge for parts or labour, the DURAVAC PRO SERIES, if proven defective in material or workmanship, during the following time period(s) after date of original retail purchase:

For 12 months use - DURAVAC PRO30L & PRO31M (excluding accessories)

2. WHO GIVES THIS WARRANTY (Warrantor):

EUROQUIP NZ	EUROQUIP AUSTRALIA
Service Line:	Service Line:
+ + 64 3 547 8409	1 - 800 040 947

3. WHO RECEIVES THIS WARRANTY (Purchaser):

The original purchaser of this DURAVAC PRO SERIES

4. WHAT IS COVERED UNDER THIS WARRANTY:

Defects in material and workmanship which occur within the duration of the warranty period.

5. WHAT IS NOT COVERED UNDER THIS WARRANTY:

- A. Implied warranties, including those of merchantability and FITNESS for a particular purpose are limited in duration to this express warranty. After this period, all risks of loss, from whatever reason, shall be on the purchaser.
- B. ANY INCIDENTAL, INDIRECT, OR CONSEQUENTIAL LOSS, DAMAGE, OR EXPENSE THAT MAY RESULT FROM ANY DEFECT, FAILURE OR MALFUNCTION OF THIS PRODUCT.
- C. This warranty does not apply to any accessory or consumable items included with the product which are subject to wear from usage; the repair or replacement of these items shall be at the expense of the owner. These items include, but are not limited to: hose's, floor tools, filters, bags, etc. In addition, this warranty does not extend to any damage caused by the untimely replacement or maintenance of any of the previously listed CONSUMABLE parts.
- D. Any failure that results from accident, purchaser's abuse, neglect or failure to operate products in accordance with instructions provided in the owner's manual(s) supplied with the product.
- E. Pre-delivery service, i.e. assembly and adjustment.

6. RESPONSIBILITIES OF WARRANTOR UNDER THIS WARRANTY:

Repair or replace, at Warrantor's option, products or components which have failed within duration of the warranty period.

7. RESPONSIBILITIES OF PURCHASER UNDER THIS WARRANTY:

- A. Please call your re-seller or the number listed above for warranty assistance.
- B. Provide dated proof of purchase and maintenance records.
- C. All vacuum must be delivered or shipped to the nearest Service Agent or re-seller. Freight costs, if any, must be borne by the purchaser.
- D. Use reasonable care in the operation and maintenance of the products as described in the owner's manual(s).
- E. No warranty costs incurred will be considered for, or covered if Euroquip has not been contacted and prior permission for repair / replacement has been granted.

8. WHEN WARRANTOR WILL PERFORM REPAIR OR REPLACEMENT UNDER THIS WARRANTY:

Repair or replacement will be scheduled and serviced according to the normal work flow at the servicing location and depending on the availability of replacement parts.



Congratulations on your new DURAVAC product. We are proud to have you as our customer and will strive to provide you with the best service and reliability in the industry. This product is backed by our extensive warranty. To locate your nearest distributor or service agency call **0800 387 678**, or email us at **customerservice@euroquip.co.nz**.